

REV	REVISION	DRAWN BY	APPROVAL	DATE
01	INITIAL MANUFACTURING RELEASE	AJC	AJC	04/01/14

ITEM	PART NUMBER	REV	DESCRIPTION	DESCRIPTION 2	Qty
1	10044		RESS,14KW,LITHIUM ION PACK(A)	14KWH RESS PACK A SS	1
2	10079		CHARGER,3KW,J1772 INTERFACE	LIQUID COOLED,IP67	1
3	10083		MODULE,PATHWAYS SMART CHARGE	EPRI SUPPLIED	1
4	20326		HARNESS,GROUND STRAP,CS & SS	GRND STRP FOR NEW RESS HOUSING	1
5	30032		WASHER, FLAT, M8X24MM OD	ZPS	10
6	30053		BOLT,FLANGE HEAD,M10X1.5X30MM	ZPS,GR 8.8	20
7	30062		NUT,FLANGE,M10X1.5MM	ZPS,GRADE 8.8	8
8	30069		BOLT,FLANGE HEAD,M8X1.25X20MM	ZPS,GR 8.8	10
9	30108		BOLT,FLANGE HEAD,M6X1.0X12MM	ZPS,GR 8.8	6
10	30143		BOLT,FLANGE HEAD,M5X0.8X8MM	ZPS,GR 8.8	4
11	40159	03	BRACKET,RESS WELDMENT ASSY	JCI RESS,84" CA	1
12	40160	02	BRACKET,TOP TUBE ASSY	JCI RESS,84" CA	2
13	40209	03	BRACKET,CHARGER MTG PLATE	JCI RESS,84" CA	1
14	40222	01	BRACKET,EPRI MPR MOUNTING	SMART CHARGER MODULE MOUNTING	1
15	50061		ADAPTER,1/2NPT TO 10ORFS		1
16	50066		ADAPTER,3/4NPT TO 10ORFS		1
17	50068		HOSE END,45 DEG,10-10,PUSHLOC	ORFS,801 HOSE	1
18	50069		HOSE END,90 DEG,10-10,PUSHLOC	ORFS,801 HOSE,SHORT DROP	1
20	50072		HOSE,5/8",BLACK		60 CM
21	50077		CLAMP,HOSE,BAND,25MM	CONSTANT TENSION	1

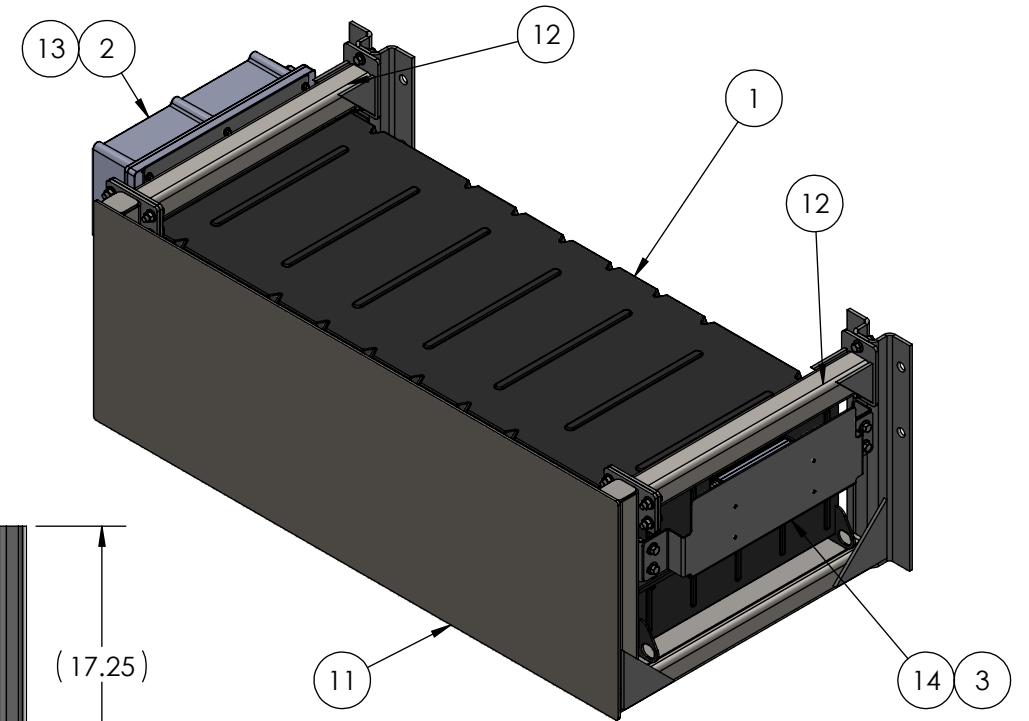
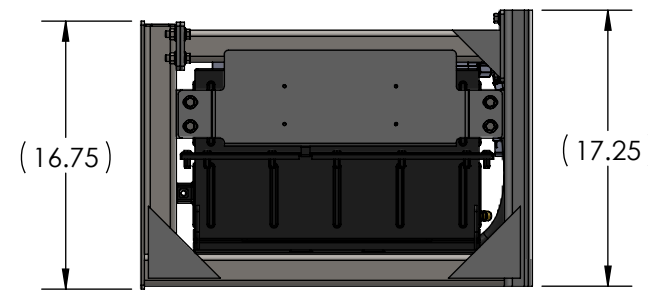
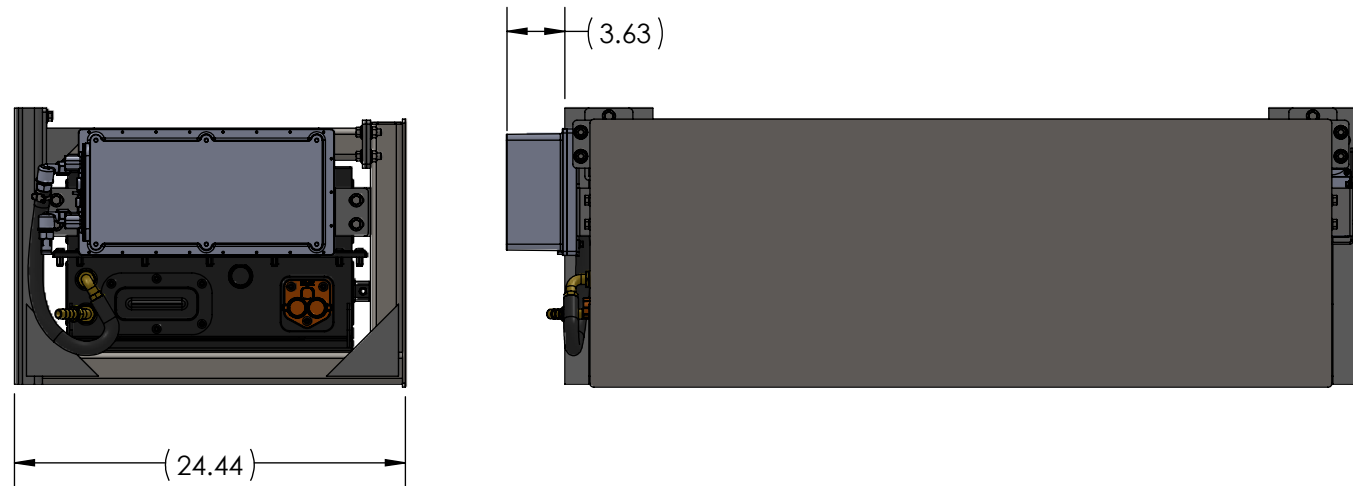
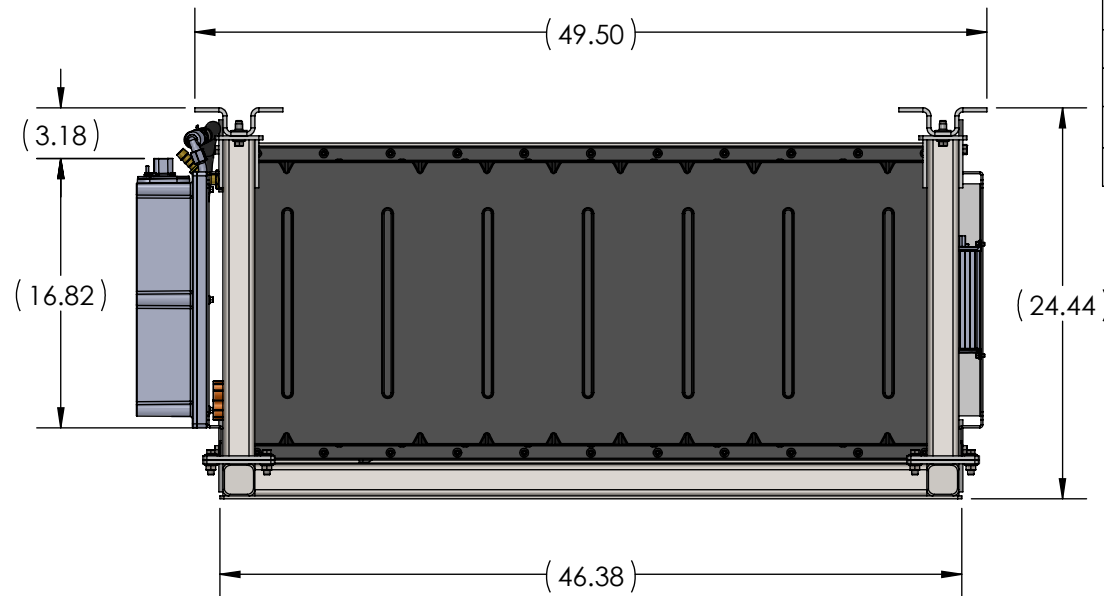

PROPRIETARY AND CONFIDENTIAL
THE INFORMATION CONTAINED IN THIS DRAWING IS THE SOLE PROPERTY OF ODYNE SYSTEMS LLC. REPRODUCTION IN PART OR AS A WHOLE WITHOUT THE WRITTEN PERMISSION OF ODYNE IS PROHIBITED.

UNLESS OTHERWISE SPECIFIED REFERENCE DIMENSIONS SHOWN IN PARENTHESIS DIMENSIONS ARE IN INCHES	DRAWN	AJC	04/01/14
	CHECKED	AJC	04/01/14
ANGULAR ± 1.0°	ENG APPR	AJC	4/1/2014
NOMINAL ± 0.125	MFG APPR	AJC	04/01/14
ONE PLACE DECIMAL ± 0.060	QA APPR		
TWO PLACE DECIMAL ± 0.030			
THREE PLACE DECIMAL ± 0.010			
MATERIAL	INTERPRET GEOMETRIC TOLERANCE PER ASME Y14.5M-1994		
FINISH			



SUB ASSY,RESS,STREETSIDE
JCI RESS,CHARGER

SIZE B	PART NUMBER 70204	REV 01
SCALE 1:12	DO NOT SCALE DRAWING	SHEET 1 OF 6

REV	REVISION	DRAWN BY	APPROVAL	DATE
01	INITIAL MANUFACTURING RELEASE	AJC	AJC	04/01/14

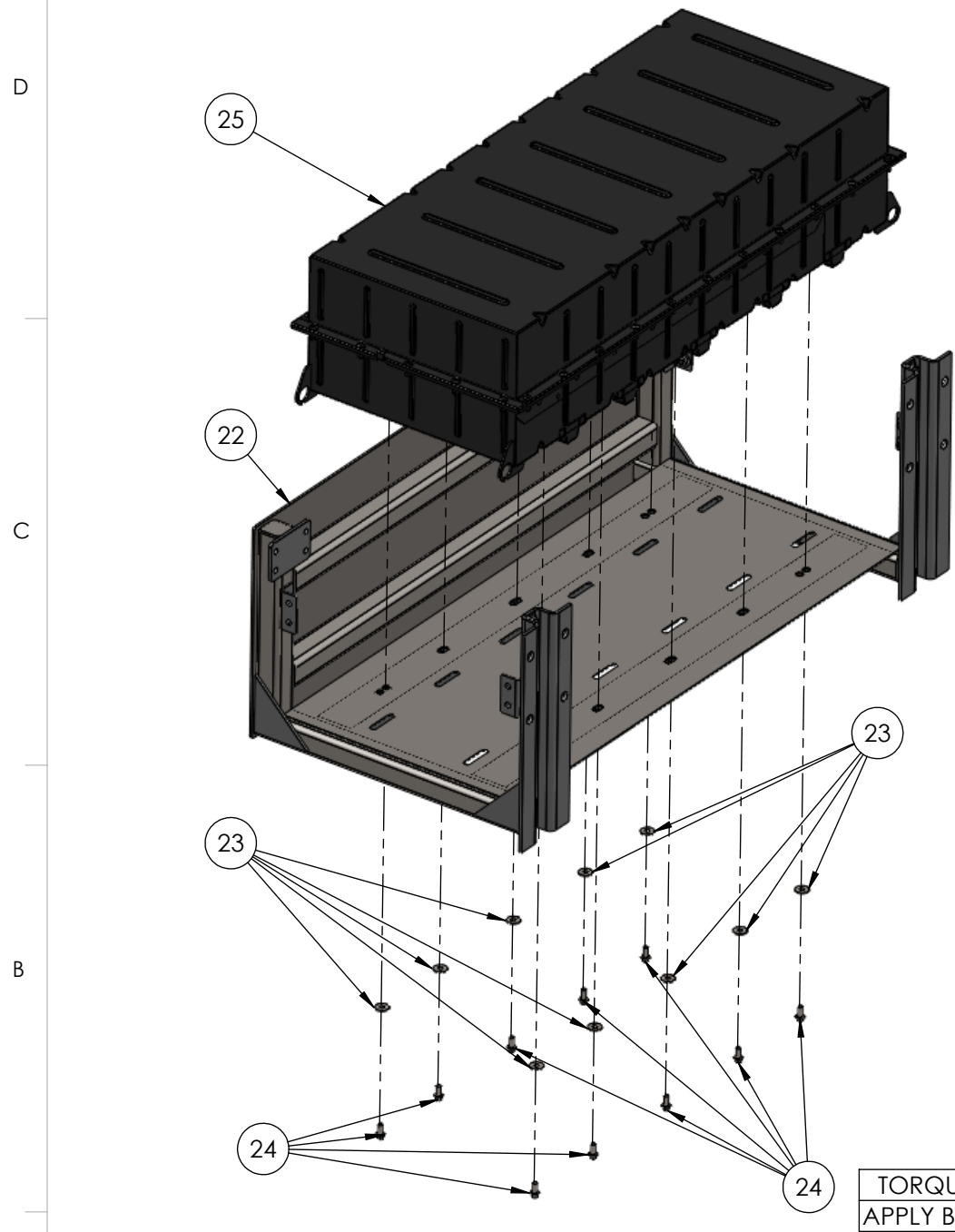

ITEM	PART NUMBER	REV	DESCRIPTION	DESCRIPTION 2	Qty
22	40159	03	BRACKET,RESS WELDMNT ASSY	JCI RESS,84" CA	1
23	30032		WASHER, FLAT, M8X24MM OD	ZPS	10
24	30069		BOLT,FLANGE HEAD,M8X1.25X20MM	ZPS,GR 8.8	10
25	10044		RESS,14KW,LITHIUM ION PACK(A)	14KWH RESS PACK A SS	1

BATTERY INSTALLATION

TORQUE VALUE 26 FT-LB
APPLY BLUE LOCTITE TO BOLT THREADS

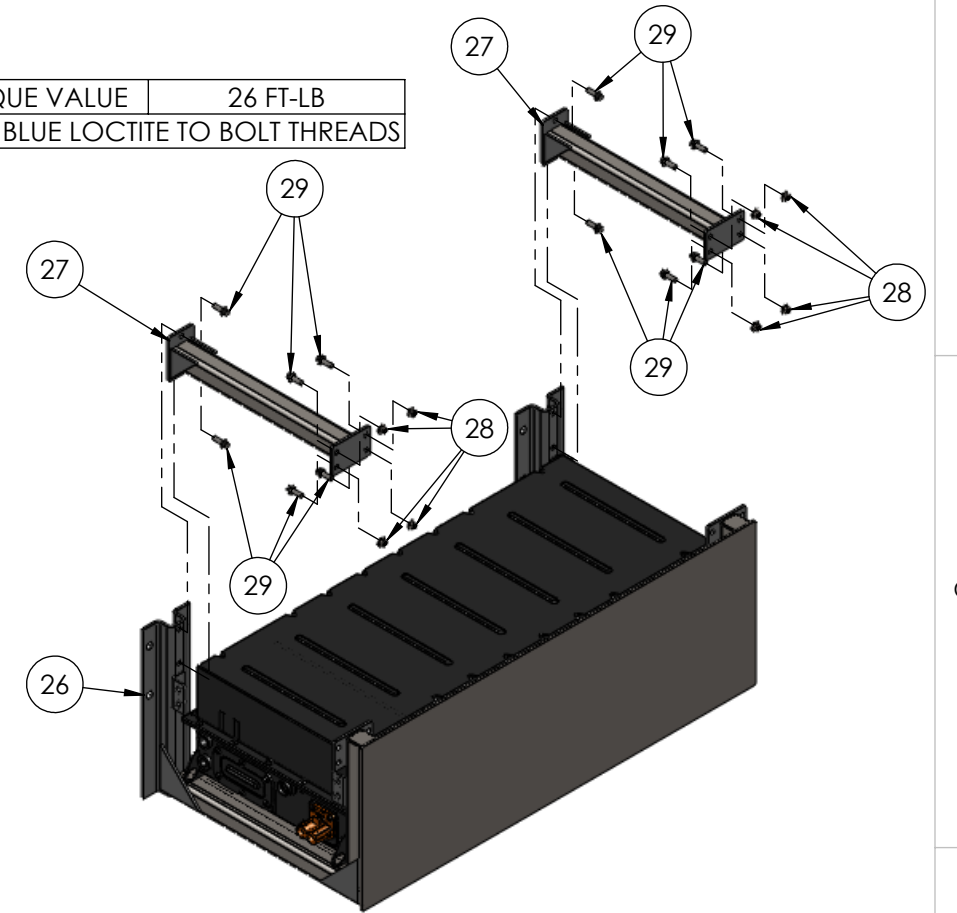

ITEM	PART NUMBER	REV	DESCRIPTION	DESCRIPTION 2	Qty
26	40159	03	BRACKET,RESS WELDMNT ASSY	JCI RESS,84" CA	1
27	40160	02	BRACKET, TOP TUBE ASSY	JCI RESS,84" CA	2
28	30062		NUT,FLANGE,M10X1.5MM	ZPS,GRADE 8.8	8
29	30053		BOLT,FLANGE HEAD,M10X1.5X30MM	ZPS,GR 8.8	12

TOP BATTERY BRACKET INSTALLATION

PROPRIETARY AND CONFIDENTIAL
THE INFORMATION CONTAINED IN THIS DRAWING IS THE SOLE PROPERTY OF ODYNE SYSTEMS, LLC.
REPRODUCTION IN PART OR AS A WHOLE WITHOUT THE WRITTEN PERMISSION OF ODYNE IS PROHIBITED.

UNLESS OTHERWISE SPECIFIED REFERENCE DIMENSIONS SHOWN IN PARENTHESIS DIMENSIONS ARE IN INCHES	DRAWN	AJC	04/01/14
	CHECKED	AJC	04/01/14
ANGULAR NOMINAL ± 1.0° ± 0.125	ENG APPR	AJC	4/1/2014
ONE PLACE DECIMAL ± 0.060	MFG APPR	AJC	04/01/14
TWO PLACE DECIMAL ± 0.030	QA APPR		
THREE PLACE DECIMAL ± 0.010			

MATERIAL
INTERPRET GEOMETRIC TOLERANCE PER
ASME Y14.5M-1994



SUB ASSY,RESS,STREETSIDE
JCI RESS,CHARGER

SIZE	PART NUMBER	REV
B	70204	01
SCALE 1:12	DO NOT SCALE DRAWING	SHEET 2 OF 6

REV	REVISION	DRAWN BY	APPROVAL	DATE
01	INITIAL MANUFACTURING RELEASE	AJC	AJC	04/01/14

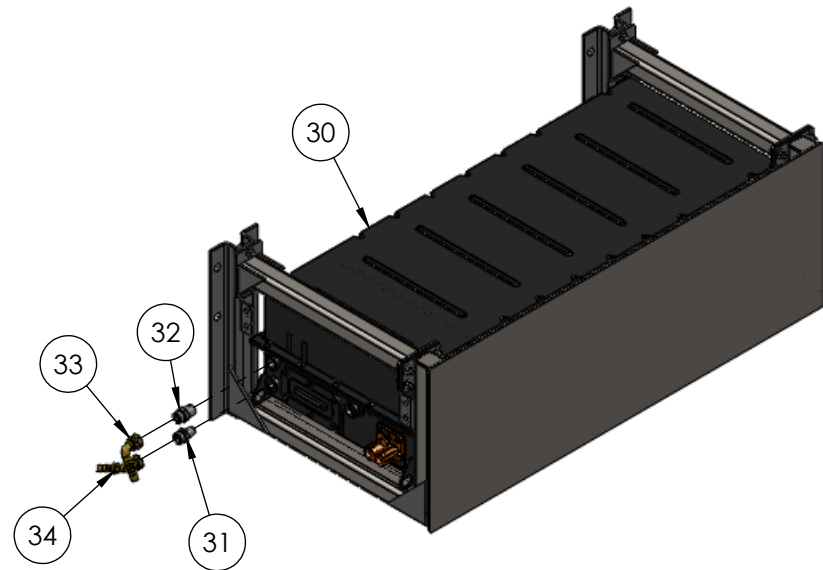

ITEM	PART NUMBER	REV	DESCRIPTION	DESCRIPTION 2	Qty
30	10044		RESS,14KW,LITHIUM ION PACK(A)	14KWH RESS PACK A SS	1
31	50061		ADAPTER,1/2NPT TO 10ORFS		1
32	50066		ADAPTER,3/4NPT TO 10ORFS		1
33	50069		HOSE END,90 DEG,10-10,PUSHLOC	ORFS,801 HOSE,SHORT DROP	1
34	50068		HOSE END,45 DEG,10-10,PUSHLOC	ORFS,801 HOSE	1

BATTERY HOSE FITTING INSTALLATION

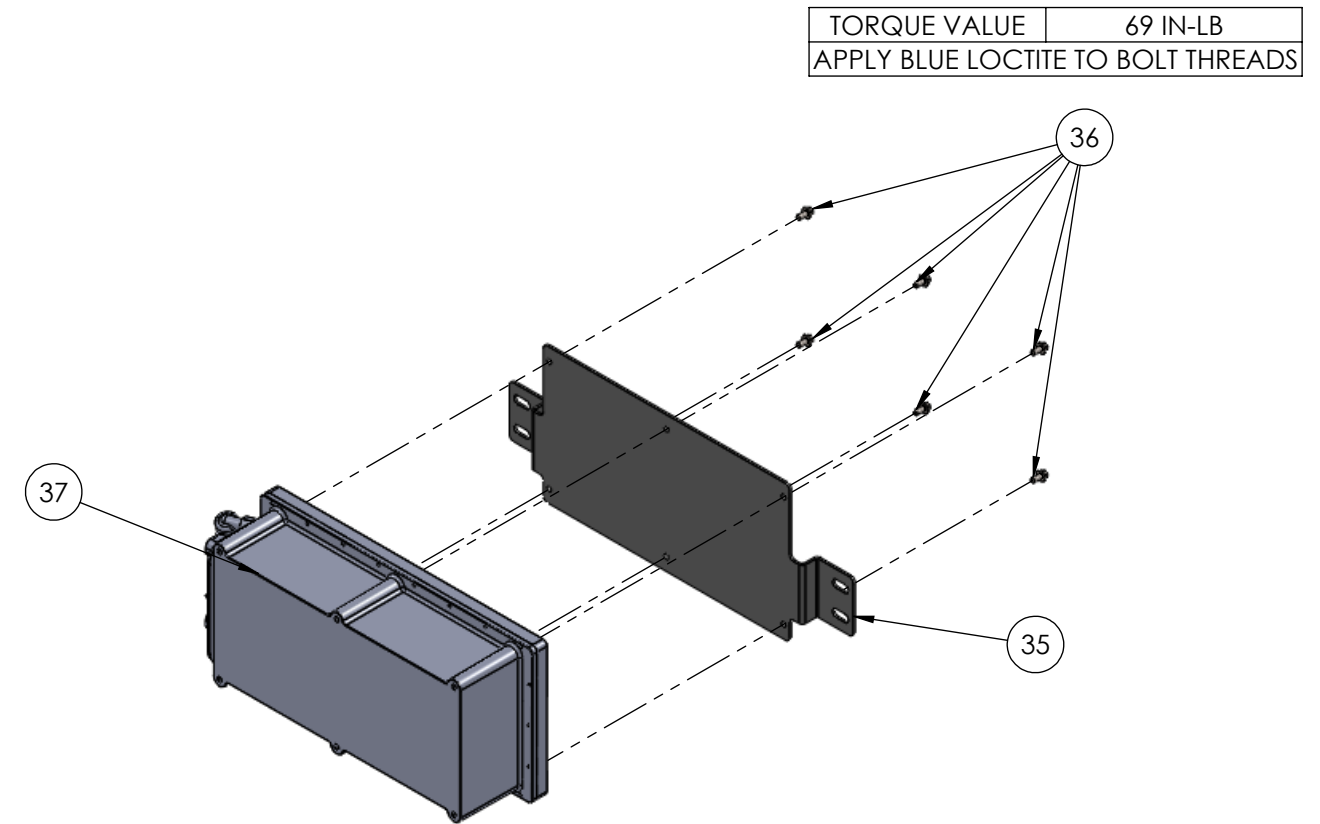

TORQUE VALUE	69 IN-LB
APPLY BLUE LOCTITE TO BOLT THREADS	

ITEM	PART NUMBER	REV	DESCRIPTION	DESCRIPTION 2	Qty
35	40209	03	BRACKET,CHARGER MTG PLATE	JCI RESS,84" CA	1
36	30108		BOLT,FLANGE HEAD,M6X1.0X12MM	ZPS,GR 8.8	6
37	10079		CHARGER,3KW,J1772 INTERFACE	LIQUID COOLED,IP67	1

BATTERY CHARGER TO CHARGER BRACKET INSTALLATION

PROPRIETARY AND CONFIDENTIAL
THE INFORMATION CONTAINED IN THIS DRAWING IS THE SOLE PROPERTY OF ODYNE SYSTEMS, LLC.
REPRODUCTION IN PART OR AS A WHOLE WITHOUT THE WRITTEN PERMISSION OF ODYNE IS PROHIBITED.

UNLESS OTHERWISE SPECIFIED
REFERENCE DIMENSIONS SHOWN IN PARENTHESIS
DIMENSIONS ARE IN INCHES

ANGULAR ± 1.0°
NOMINAL ± 0.125
ONE PLACE DECIMAL ± 0.060
TWO PLACE DECIMAL ± 0.030
THREE PLACE DECIMAL ± 0.010

MATERIAL

FINISH

DRAWN	AJC	04/01/14
CHECKED	AJC	04/01/14
ENG APPR	AJC	4/1/2014
MFG APPR	AJC	04/01/14
QA APPR		

INTERPRET GEOMETRIC TOLERANCE PER
ASME Y14.5M-1994

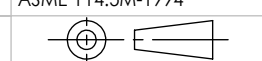

SUB ASSY,RESS,STREETSIDE
JCI RESS,CHARGER

SIZE B	PART NUMBER 70204	REV 01
SCALE 1:12	DO NOT SCALE DRAWING	SHEET 3 OF 6

REV	REVISION	DRAWN BY	APPROVAL	DATE
01	INITIAL MANUFACTURING RELEASE	AJC	AJC	04/01/14

D

D

C

C

B

B

A

A

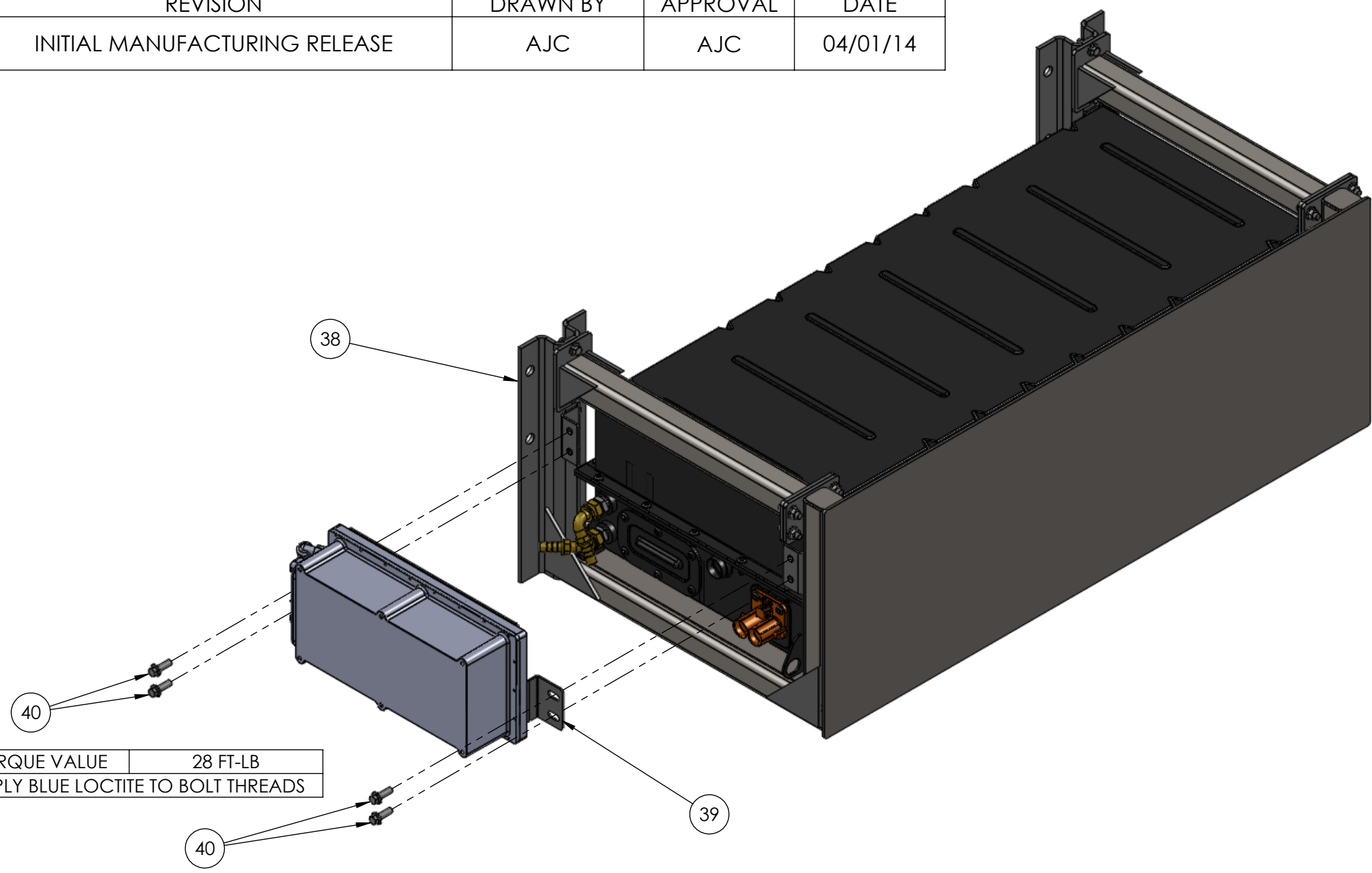

TORQUE VALUE	28 FT-LB
APPLY BLUE LOCTITE TO BOLT THREADS	

ITEM	PART NUMBER	REV	DESCRIPTION	DESCRIPTION 2	Qty
38	40159	03	BRACKET,RESS WELDMENT ASSY	JCI RESS,84" CA	1
39	40209	03	BRACKET,CHARGER MTG PLATE	JCI RESS,84" CA	1
40	30053		BOLT,FLANGE HEAD,M10X1.5X30MM	ZPS,GR 8.8	4

BATTERY CHARGER BRACKET INSTALLATION

PROPRIETARY AND CONFIDENTIAL
 THE INFORMATION CONTAINED IN THIS DRAWING IS THE SOLE PROPERTY OF ODYNE SYSTEMS LLC.
 REPRODUCTION IN PART OR AS A WHOLE WITHOUT THE WRITTEN PERMISSION OF ODYNE IS PROHIBITED.

UNLESS OTHERWISE SPECIFIED REFERENCE DIMENSIONS SHOWN IN PARENTHESIS DIMENSIONS ARE IN INCHES	DRAWN	AJC	04/01/14
	CHECKED	AJC	04/01/14
ANGULAR NOMINAL ± 1.0°	ENG APPR	AJC	4/1/2014
± 0.125	MFG APPR	AJC	04/01/14
ONE PLACE DECIMAL ± 0.060	QA APPR		
TWO PLACE DECIMAL ± 0.030			
THREE PLACE DECIMAL ± 0.010			
MATERIAL	INTERPRET GEOMETRIC TOLERANCE PER ASME Y14.5M-1994		
FINISH			



SUB ASSY,RESS,STREETSIDE
 JCI RESS,CHARGER

SIZE B	PART NUMBER 70204	REV 01
SCALE 1:12	DO NOT SCALE DRAWING	SHEET 4 OF 6

REV	REVISION	DRAWN BY	APPROVAL	DATE
01	INITIAL MANUFACTURING RELEASE	AJC	AJC	04/01/14

TORQUE VALUE	41 IN-LB
APPLY BLUE LOCTITE TO BOLT THREADS	

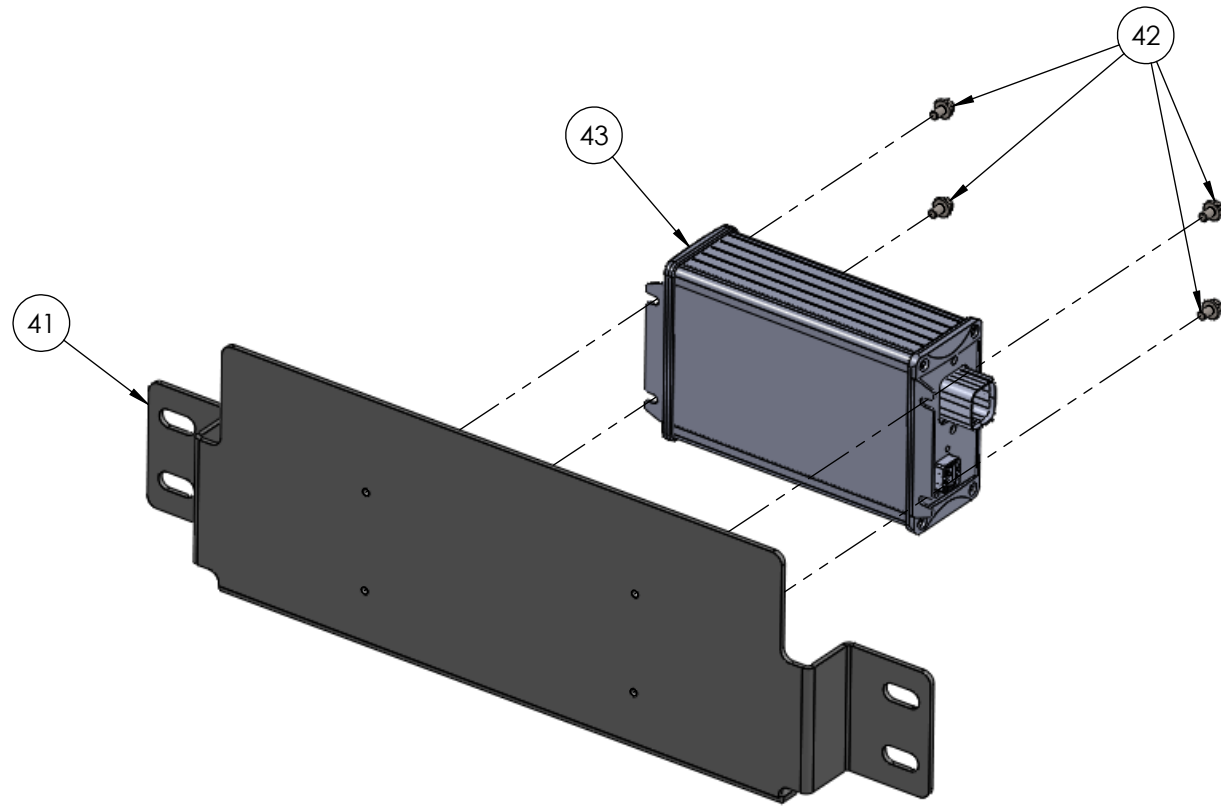

TORQUE VALUE	28 FT-LB
APPLY BLUE LOCTITE TO BOLT THREADS	

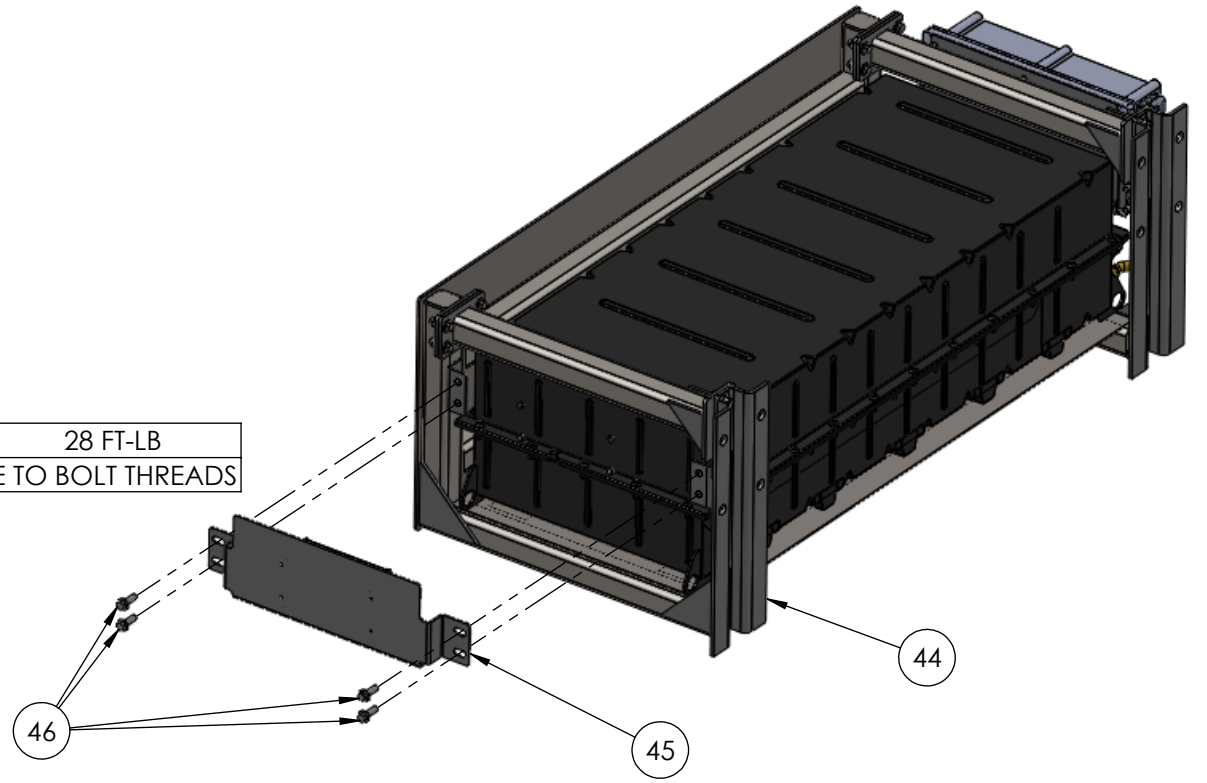

ITEM	PART NUMBER	REV	DESCRIPTION	DESCRIPTION 2	Qty
41	40222	01	BRACKET,EPRI MPR MOUNTING	SMART CHARGER MODULE MOUNTING	1
42	30143		BOLT,FLANGE HEAD,M5X0.8X8MM	ZPS,GR 8.8	4
43	10083		MODULE,PATHWAYS SMART CHARGE	EPRI SUPPLIED	1

PATHWAYS INSTALLATION

ITEM	PART NUMBER	REV	DESCRIPTION	DESCRIPTION 2	Qty
44	40159	03	BRACKET,RESS WELDMENT ASSY	JCI RESS,84" CA	1
45	40222	01	BRACKET,EPRI MPR MOUNTING	SMART CHARGER MODULE MOUNTING	1
46	30053		BOLT,FLANGE HEAD,M10X1.5X30MM	ZPS,GR 8.8	4

PATHWAYS BRACKET INSTALLATION

PROPRIETARY AND CONFIDENTIAL
 THE INFORMATION CONTAINED IN THIS DRAWING IS THE SOLE PROPERTY OF ODYNE SYSTEMS, LLC.
 REPRODUCTION IN PART OR AS A WHOLE WITHOUT THE WRITTEN PERMISSION OF ODYNE IS PROHIBITED.

UNLESS OTHERWISE SPECIFIED REFERENCE DIMENSIONS SHOWN IN PARENTHESIS DIMENSIONS ARE IN INCHES	DRAWN	AJC	04/01/14
	CHECKED	AJC	04/01/14
ANGULAR ± 1.0°	ENG APPR	AJC	4/1/2014
NOMINAL ± 0.125	MFG APPR	AJC	04/01/14
ONE PLACE DECIMAL ± 0.060	QA APPR		
TWO PLACE DECIMAL ± 0.030			
THREE PLACE DECIMAL ± 0.010			
MATERIAL	INTERPRET GEOMETRIC TOLERANCE PER ASME Y14.5M-1994		
FINISH			



SUB ASSY,RESS,STREETSIDE
 JCI RESS,CHARGER

SIZE B	PART NUMBER 70204	REV 01
SCALE 1:12	DO NOT SCALE DRAWING	SHEET 5 OF 6

REV	REVISION	DRAWN BY	APPROVAL	DATE
01	INITIAL MANUFACTURING RELEASE	AJC	AJC	04/01/14

ITEM	PART NUMBER	REV	DESCRIPTION	DESCRIPTION 2	Qty
47	50072		HOSE,5/8",BLACK		60 CM
48	50077		CLAMP,HOSE,BAND,25MM	CONSTANT TENSION	1

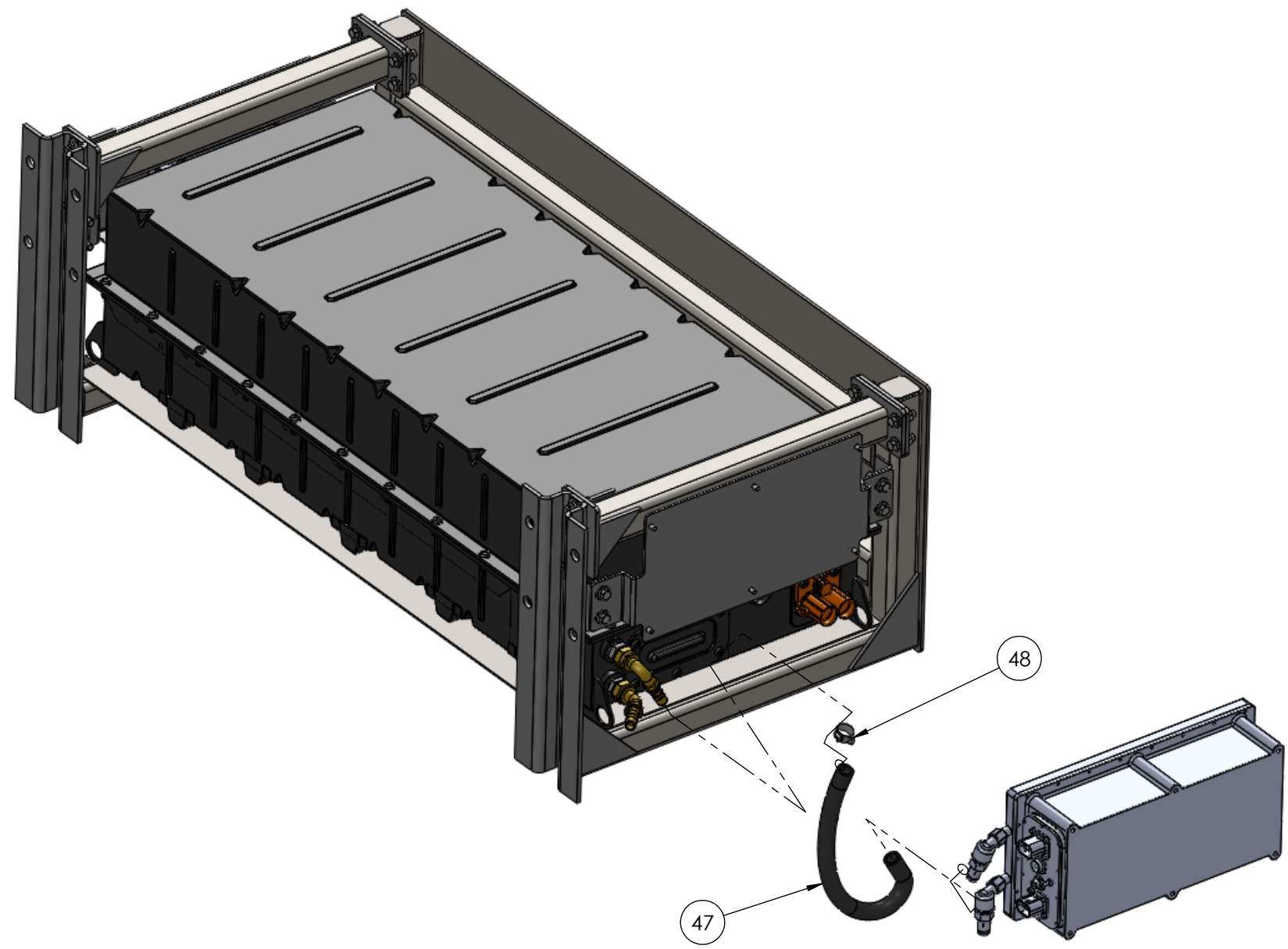

PROPRIETARY AND CONFIDENTIAL
 THE INFORMATION CONTAINED IN THIS DRAWING IS THE SOLE PROPERTY OF ODYNE SYSTEMS, LLC.
 REPRODUCTION IN PART OR AS A WHOLE WITHOUT THE WRITTEN PERMISSION OF ODYNE IS PROHIBITED.

UNLESS OTHERWISE SPECIFIED REFERENCE DIMENSIONS SHOWN IN PARENTHESIS DIMENSIONS ARE IN INCHES	DRAWN	AJC	04/01/14
	CHECKED	AJC	04/01/14
ANGULAR ± 1.0°	ENG APPR	AJC	4/1/2014
NOMINAL ± 0.125	MFG APPR	AJC	04/01/14
ONE PLACE DECIMAL ± 0.060	QA APPR		
TWO PLACE DECIMAL ± 0.030			
THREE PLACE DECIMAL ± 0.010			
MATERIAL	INTERPRET GEOMETRIC TOLERANCE PER ASME Y14.5M-1994		
FINISH			



SUB ASSY,RESS,STREETSIDE
 JCI RESS,CHARGER

SIZE B	PART NUMBER 70204	REV 01
SCALE 1:8	DO NOT SCALE DRAWING	SHEET 6 OF 6